

MONS AVENUE

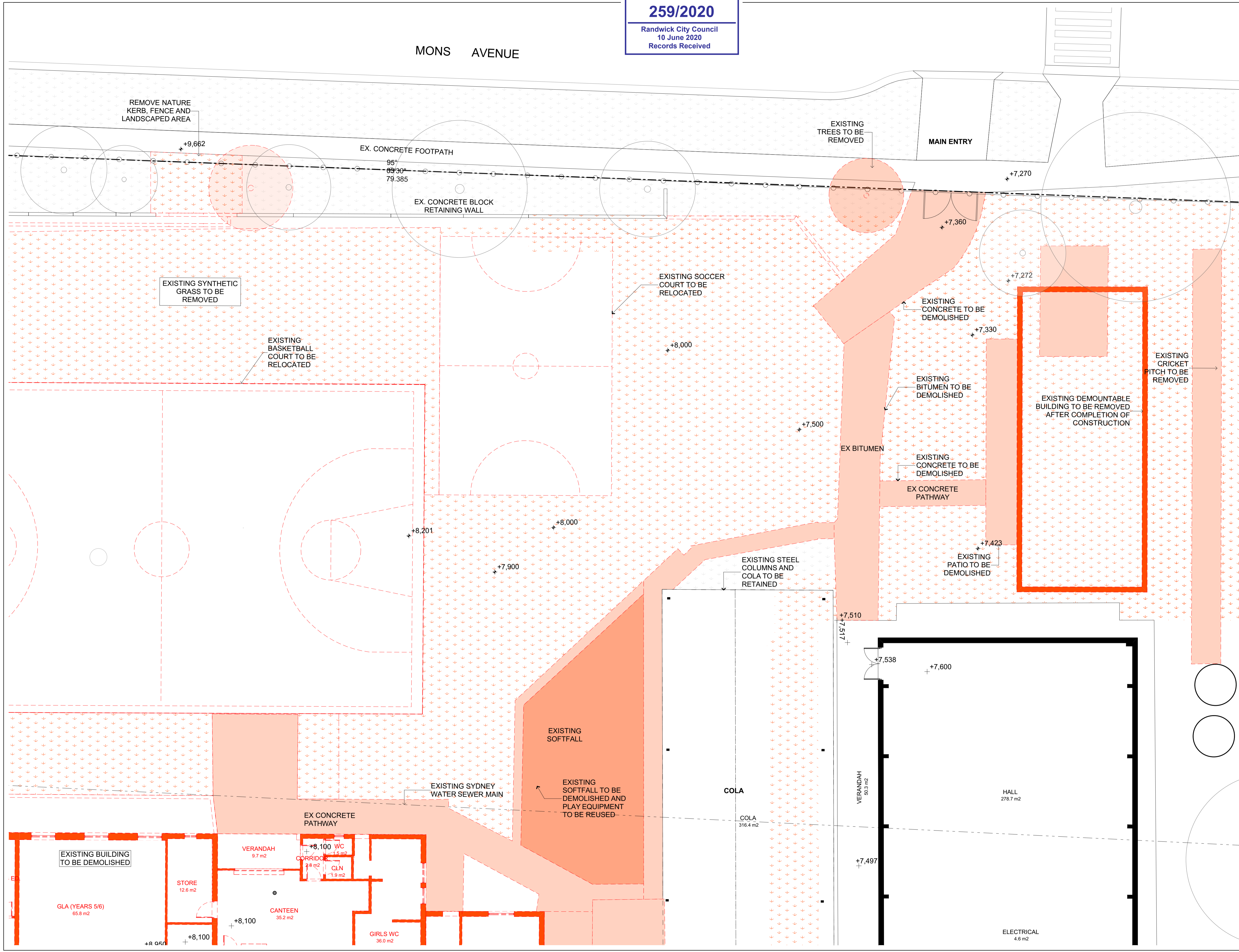

© COPYRIGHT JDH ARCHITECTS PTY. LTD.  
 THE CONTRACTOR SHALL CHECK AND VERIFY ALL DIMENSIONS AND VERIFY ALL ERRORS AND OMISSIONS TO THE ARCHITECT. USE FIGURATIVE DIMENSIONS. DO NOT SCALE THE DRAWINGS. DRAWINGS SHALL NOT BE USED FOR CONSTRUCTION PURPOSES UNTIL ISSUED BY THE ARCHITECT FOR CONSTRUCTION.

Rev	Date	By	Issue Name	CHK
A	18-05-2020	DF	Issued for DA	SH

**DEMOLITION LEGEND**

- EXISTING BUILDINGS
- EXISTING LAWN / GARDEN
- EXISTING LANDSCAPE TO BE DEMOLISHED
- EXISTING BUILDINGS TO BE DEMOLISHED
- SITE BOUNDARY
- INTERNAL LOT BOUNDARY
- NEIGHBOURING BOUNDARY
- EXISTING TREE TO BE RETAINED
- EXISTING TREE TO BE REMOVED
- SITE ENTRY
- EXISTING PATH TO BE REMOVED
- EXISTING SECURITY FENCE
- EXISTING WALL
- WALL TO BE DEMOLISHED

Building Certifier

Mechanical, Electrical & Hydraulic Engineering Consultant

Structural & Civil Engineer Consultant

Architect  
**JDHarchitects**  
 JDH ARCHITECTS PTY. LTD.  
 info@jdharchitects.com.au  
 AIN: 27 110 978 802  
 ACH: 110 978 802  
 NOMINATED ARCHITECT: JAYNE HARRISON (7403)

Client  
  
 38 Renwick St  
 Leichhardt  
 NSW, 2040  
 Telephone: 9569 6111  
 Fax: 9550 0052  
 www.ceosyd.catholic.edu.au

Project Name  
**ST MARY ST JOSEPH CPS, MAROUBRA**  
 280 FITZGERALD AVE,  
 MAROUBRA NSW 2035

Drawing Title  
**ZONE A - DEMOLITION GROUND FLOOR PLAN**  
 Scale: 1:100 @A1 Date: 29-05-2020  
 Drawn: DF Checked: SH

Project No. 1076 Drawing No. DA-101 Rev. A

QUALITY CERTIFIED ISO 9001  
 INITIALING THE 'DRAWN AND THE CHECK BOXES CONFIRMS THAT THIS DRAWING HAS BEEN PREPARED IN CONFORMANCE WITH JDH ARCHITECTS Q.M.S. PROCEDURES.

Status: DEVELOPMENT APPLICATION